

HUBLLOT 7 WOOD AIR

Wood stoves

CADEL

Certificate model name: HUBLLOT 7 WOOD AIR T1



Nominal power	kW	7
Reduced power	kW	-
Introduced thermal power (max)	kW	8,4
Nominal water useful power	kW	-
Reduced water useful power	kW	-
Seasonal energy efficiency	ηs [%]	74
Nominal efficiency	%	84
Reduced efficiency	%	-
Heating volume (min-max)	m³	196
Nominal CO at 13% O ₂	%	0,1
Reduced CO at 13% O ₂	%	-
Emissions CO (13% O ₂) (min-max)	mg/Nm³	1250
Emissions OGC (13% O ₂) (min-max)	mg/Nm³	60
Emissions NOX (13% O ₂) (min-max)	mg/Nm³	110
Dust content at 13% O ₂ (min-max)	mg/Nm³	30
Boiler capacity (H ₂ O)	l	-
Hopper capacity	kg	-
Combustible		Legna
Hourly consumption (min-max)	kg/h	1,9
Autonomy (min-max)	h	-
Ignition electrical absorption (max)	W	-
Operating electrical absorption (max)	W	20
Supply and frequency	V - Hz	230 - 50
Chimney flue depression	Pa	12
Mass of smoke (min-max)	g/sec	6,7
Exhaust fumes temperature (max)	°C	176
Net weight	kg	140
Gross weight	kg	150
Exhaust fumes (A)	Ø mm	150
Hole combustion air inlet (B)	Ø mm	80
Ducting outlet (C)	Ø mm	-
Ducting capability up to	m	-

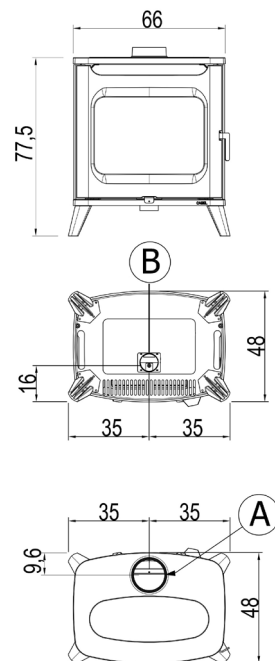

MATCH

7024015  Black steel

EAN 8053859020714



PLUS



Cast iron door



Central Top exhaust



Refractory stone inner with 2nd combustion air



Maximum length of the wooden log



Sealed chamber



Anti-smoke valve



Ventilation

STOVE PACKING

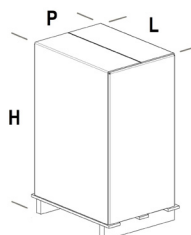

L (cm)	H (cm)	P (cm)
79	94	70

VOLUME (m³)
0,52

LINING PACKING

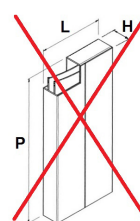

L (cm)	H (cm)	P (cm)

STOCKING

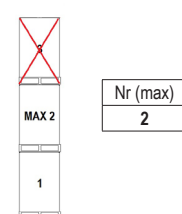

TRANSPORT

