

KRISS 9

PELLET AIR - Pellet stoves



Certificate model name : KRISS3 - 8,5kW



Nominal power	kW	8,6
Reduced power	kW	2,4
Introduced thermal power (max)	kW	9,73
Nominal water useful power	kW	-
Reduced water useful power	kW	-
Nominal efficiency	%	89,1
Reduced efficiency	%	92,9
Heating volume (min-max)	m ³	58 - 206
Nominal CO at 13% O ₂	%	0,006
Reduced CO at 13% O ₂	%	0,022
Emissions CO (13% O ₂) (min-max)	mg/Nm ³	274 - 79
Emissions OGC (13% O ₂) (min-max)	mg/Nm ³	3,9 - 1,5
Emissions NOX (13% O ₂) (min-max)	mg/Nm ³	104 - 136
Dust content at 13% O ₂ (min-max)	mg/Nm ³	19,3 - 14
Boiler capacity (H ₂ O)	l	-
Hopper capacity	kg	18
Combustible		Pellet ø6
Hourly consumption (min-max)	kg/h	0,53 - 2,01
Autonomy (min-max)	h	9 - 34
Ignition electrical absorption (max)	W	346
Operating electrical absorption (max)	W	76
Supply and frequency	V - Hz	230 - 50
Chimney flue depression	Pa	11,6
Exhaust diameter	mm	80
Combustion air inlet diameter	mm	60
Mass of smoke (min-max)	g/sec	2,2 - 4,8
Exhaust fumes temperature (max)	°C	196,6
Net weight	kg	79
Gross weight	kg	88
Exhaust fumes	see	A
Hole combustion air inlet	see	B
Ducting outlet	see	-
Ducting capability up to	m	-

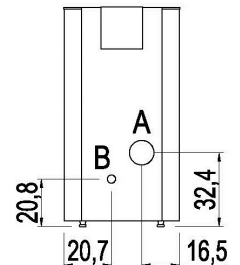
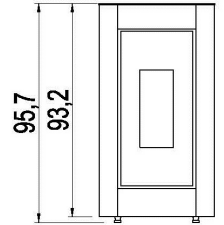
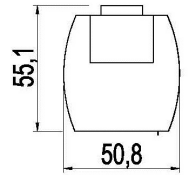

Art. 15A B-VG 2015
BImSchV 2015
Regensburg
München
Stuttgart
Aachen



MATCH

7015535		Anthracite steel	EAN 8053859014324
7015536		White steel	EAN 8053859014331
7015534		Light bronze steel	EAN 8053859014317
7015533		Red steel	EAN 8053859014300

PLUS



Cast iron burning pot



Sealed chamber



Aluminium Auger



Connection to the room thermostat



Comfort mode



Back exhaust



Integrated Wi - Fi



Cast iron door



Daily weekly programming



Bluetooth

STOVE PACKING

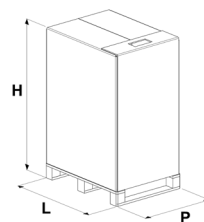

L (cm)	H (cm)	P (cm)
80	114,3	60

VOLUME (m ³)
0,55

LINING PACKING

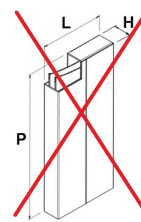

L (cm)	H (cm)	P (cm)
-	-	-

STOCKING

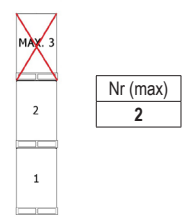

TRANSPORT

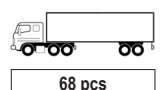

68 pcs